

The StairAide system is installed on one side of an existing staircase, and occupies just nine inches of the width of each step.

StairAide leaves ample room to climb or descend a standard staircase; by using either the Stair Aide system...
...or the remaining portion of each step.

With StairAide's easy installation, you can regain the freedom to move about your home, without the need for costly renovations or unsightly devices...

The StairAide system blends in with your existing home decor!



Use your stairs safely & easily again.



StairAide LLC - Albany, New York



For additional details or to purchase the StairAide product, please visit our website:

www.StairAide.com

or call:

(518) 833-6727

The StairAide team is dedicated to helping people continue living a full and independent lifestyle.



Use your stairs safely & easily again.



The StairAide system is available in a durable, rich oak finish, which blends seamlessly into most home decor schemes.

For more information
please visit us on the web at:
www.StairAide.com

or call:

(518) 833-6727

www.StairAide.com

Climbing stairs a problem?

The solution is a step away...

- Less Stress
- Less Pain
- Less Physical Exertion
- More Freedom

Add the StairAide system to your home...
...and climb your stairs again!

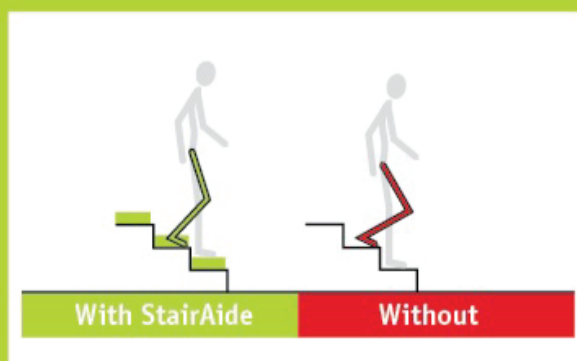

StairAide dramatically reduces the effort of stair climbing. It's like walking on a slightly inclined road as opposed to a steep hill...
...it may take longer to get to the top, but is so much easier.

Climbing stairs keeps your leg muscles strong. **StairAide** reduces strain and keeps you climbing and mobile!

If you can climb and descend your existing staircase, but find it difficult or painful (or find yourself thinking twice before going up or down stairs) then **StairAide** can help!

- Great for seniors, post-surgery rehab and occupational therapy
- Reduces stair-climbing effort - an instant improvement in quality of life
- Simple, strong and reliable - no parts to wear or break
- Retains safety aspects of conventional stairs, with unrestricted use of hand rails
- Simple, do-it-yourself installation, and surprising affordability!



Tested to withstand a load of over **1100 lbs.** with no damage!

StairAide is a small, furniture quality, half-height step that you add to each step on your staircase, doubling the effective number of steps, without any significant alterations to your home!

StairAide has been tested to withstand a load of over 1100 lbs. with no damage and can be used on both hardwood and carpeted stairs.

Installation of **StairAide** to each step requires just two screws. **As easy as...**

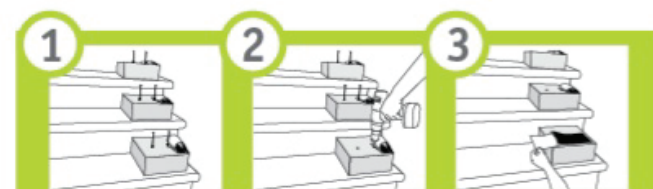

www.StairAide.com



The StairAide system is installed in a quick 3-step process!